

THIS INFORMATION IS CONFIDENTIAL AND IS DISCLOSED TO YOU ON CONDITION THAT NO FURTHER DISCLOSURE IS MADE BY YOU TO OTHER THAN TOP-LINK PERSONNEL WITHOUT WRITTEN AUTHORIZATION FROM TOP-LINK LTD.

DWG NO.  
C-100223

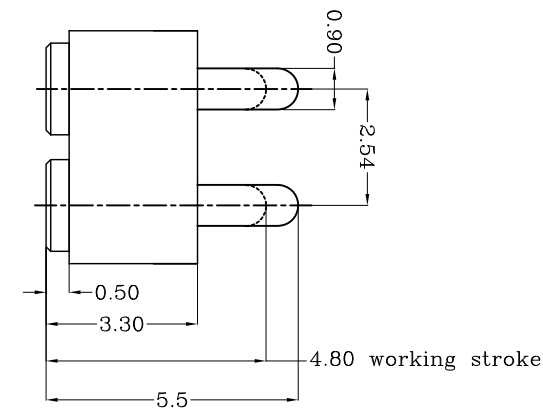
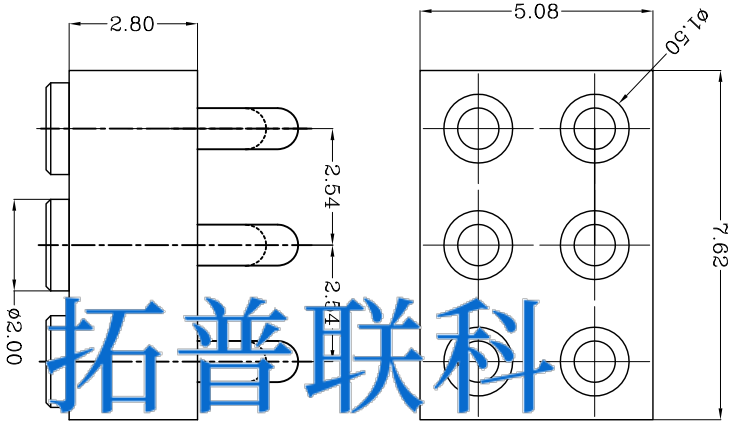
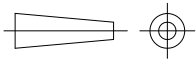

# TOP-LINK

- Notes:
- ① Material(材质)  
Housing: PA 4.6 (30% Glass Filled)  
Color Black.
  - Contact: Brass
  - Spring : Stainless steel wire(不锈钢)

- 2 Plating(电镀):  
Plunger: 0.05um Pd plating over 0.25um Pd Ni plating over 1.4um Ni  
Body: 0.05um Pd plating over 0.25um Pd Ni plating over 1.4um Ni  
Body: 底层: Ni 1.4um 中间层: Pd Ni 0.25um 表面层: Pd 0.05um
- 3 Mechanical(机械性能):  
Force: Max 60gf per pin at 0.7mm stroke  
(力: 下压0.7mm的力:60gf max)  
Total stroke(总行程) : 1.00mm  
Durability(寿命): 10,000 cycle min.

|      |   |
|------|---|
| LDC  | - |
| DIST | - |

|          |        |      |            |
|----------|--------|------|------------|
| REVISION | RECORD | APVD | DATE       |
| NEW      |        |      | 2009/10/26 |
| Renovate |        |      | 2009/11/04 |
| Renovate |        |      | 2009/11/05 |
| Renovate |        |      | 2009/11/05 |

|   |         |
|---|---------|
| DIMENSIONS IN MM                          |         |
| TOLERANCES UNLESS OTHER SPECIFIED         |         |
| 0   | = ±     |
| 0.0                                       | = ±0.15 |
| 0.00                                      | = ±0.10 |
| 0.000                                     | = ±     |
| ANGLE: ±1°                                |         |
| SURF TEXTURE: 32/                         |         |
| REMOVE BURRS, BREAK SHARP EDGES R0.05 MAX |         |
| DD NOT SCALE PRINT                        |         |

|                            |         |          |
|----------------------------|---------|----------|
| MATL                       | HT TR   | FIN      |
| DWN                        | APVD    |          |
| CHK                        | REL     |          |
| NAME                       |         |          |
| PGGD CONNECTOR 6 POSITIONS |         |          |
| PGC-1.5-5.5-2R-6P-2.54PH   |         |          |
| SCALE                      | DWG ND. |          |
| 1:1                        | A4      | C-100223 |
| SHEET                      | REV     |          |
| 1 OF 1                     | D       |          |

100223-6  
PART NUMBER

Top-Link  
Electronics Ltd.

USED DN

4

3

2

1

A

B

C

D