

THIS INFORMATION IS CONFIDENTIAL AND IS DISCLOSED TO YOU ON CONDITION THAT NO FURTHER DISCLOSURE IS MADE BY YOU TO OTHER THAN TOP-LINK PERSONNEL WITHOUT WRITTEN AUTHORIZATION FROM TOP-LINK LTD.

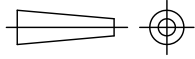

DWG NO.
C-200001-4

RECOMMENDED P.C.B LAYOUT (Component Side)

USED DN

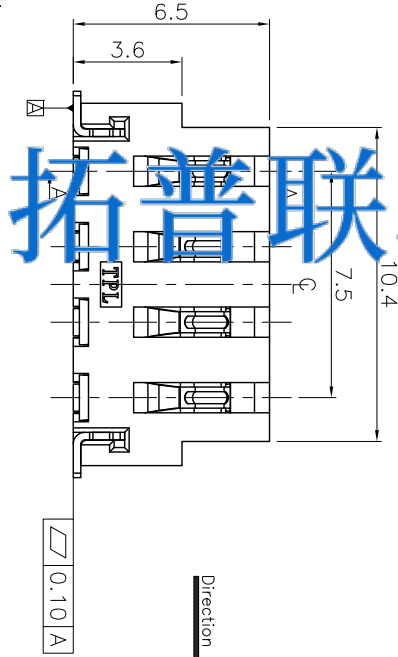
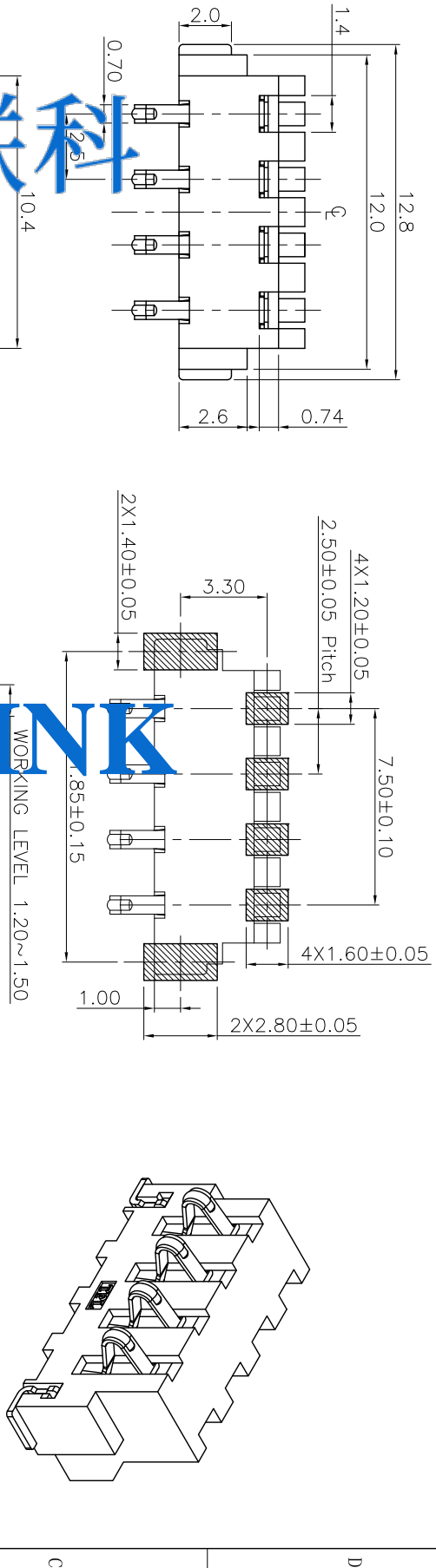

TOP-LINK

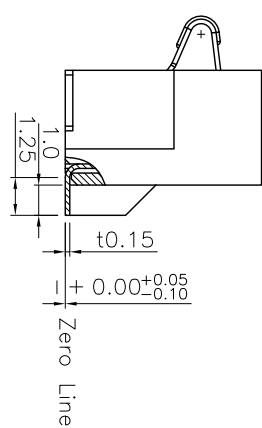

SECTION A-A

- Notes
1. Material:
Plastic: LCP (UL94V-0), color black
Terminal: beryllium copper (C1720 HM)
 2. Finish:
Battery contact: Min 15u" Gold plating over min 60u" Nickel.
Retention pad: Min 80u" Tin plating over min 60u" Nickel.
 3. Electrical specifications:
Voltage rating: 12V DC
Current rating: 2.0A max
Dielectric strength: 500V AC for 1 minute 1 mA
Insulation resistance: 1000 meg ohm min
Contact resistance: 30 mill. ohm max
Operation temperature: -40° to +105°
 4. Mechanical specifications:
Product withstanding reflow soldering 260° for 10S
Durability: 5000 cycles
Normal force at mated position: 50g min

LDC	-	增加电硬规格
DIST	-	NEW

LTR	REVISION	APVD	DATE
	RECORD		
			2011/02/18
			2007/08/16

DIMENSIONS IN MM	
TOLERANCES UNLESS	
OTHER SPECIFIED	
0	= ±
00	= ±0.15
000	= ±0.10
0000	= ±
ANGLE: ±1°	
SURF TEXTURE: 3.2/	
REMOVE BURS, BREAK	
SHARP EDGES R0.05 MAX	
DD NDT SCALE PRINT	

MATL	—	HT TR	—	FIN	—
DVN	Qin	APVD			
CHK		REL			
NAME	2.50 Pitch Spring Battery Connector				
SCALE	4:1	A4	DWG	C-200001-4	SHEET
			NO.		1 OF 2
					REV
					A

200001-4
PART NUMBER

Top-Link
Electronics L td.

4 3 2 1